

## Step 9 Starting Shaft Bearing Blocks

From parts bag 2: The Start Shaft Guide Blocks are pre-assembled. Slide the Starter Shaft through one of the block assemblies with the M5x11 Ball Bearing facing up then slide the M5 Flat Washer, spring and finally the M5x10 Collar.

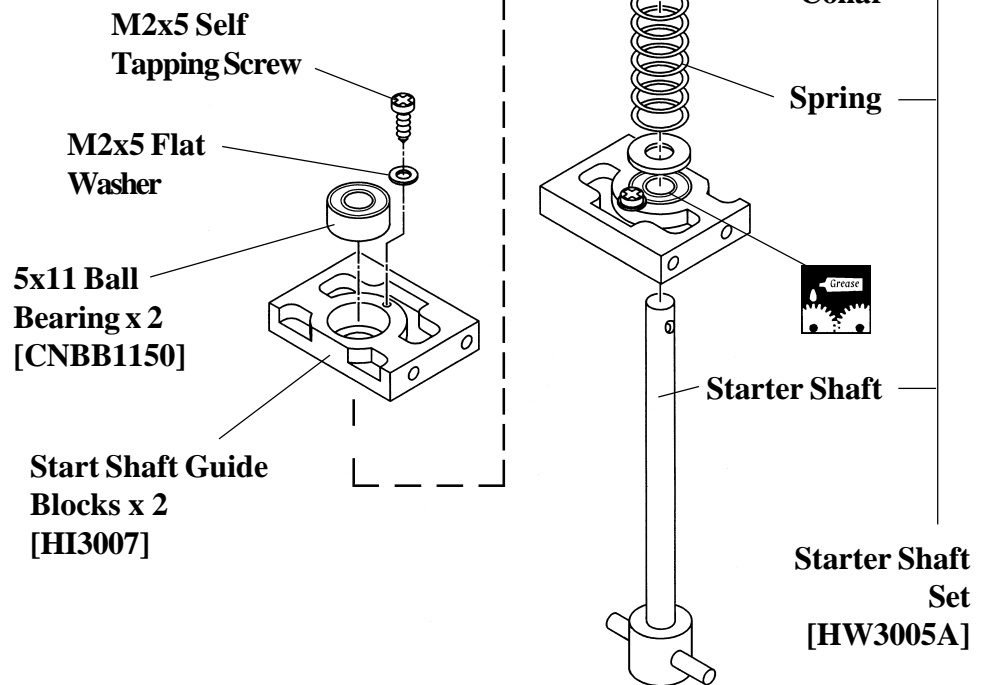

## X Hex Starter Extension (Optional Part #CN0426A)

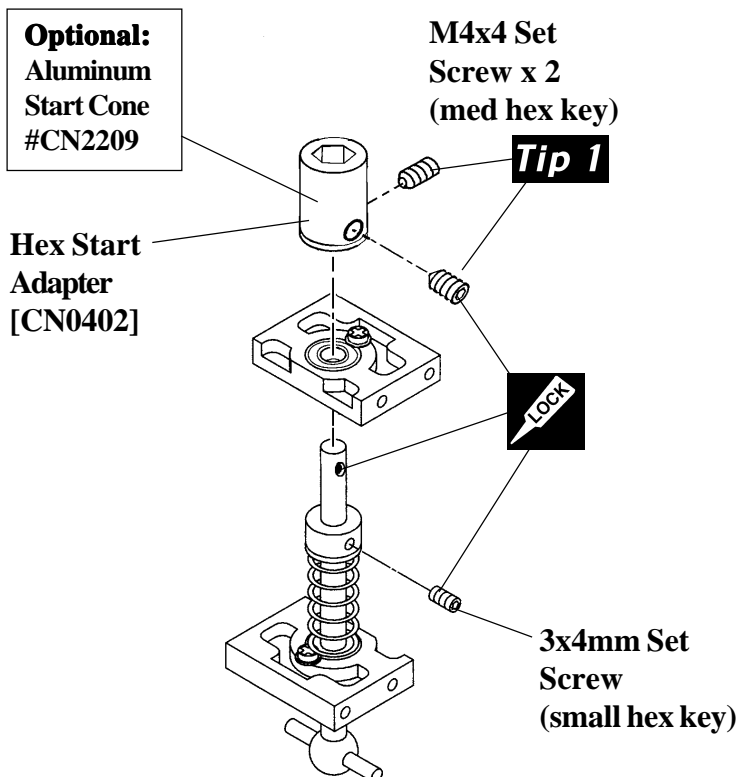

## Step 10 Starting Shaft & Hex Coupler

From parts in bag 2: After sliding the top bearing block in place, attach the hex starter adapter CN0402 to the starting shaft using threadlock on both 4x4mm set screws. Align one set screw to fit into the machined indentation in the hardened start shaft. For added strength apply a locktight to the shaft before the hex coupler is attached. Apply some lubricant on the shaft after assembly to ensure smooth vertical movement inside the inner races of the bearings when engaging and disengaging the start system. Position the M5 collar so the end of the start shaft clears the fan, verify after installing the lower frames.

## Engine Start Procedure with Hex Coupler

When removing the hex start extension after the engine has started, it is recommended that you use a two step procedure.

**Step #1:** Lift the hex extension upwards just enough to disengage the start shaft while keeping the extension inserted in the hex coupler (CN0402).

**Step #2:** After the coupler has stopped turning, then remove the extension completely.